

# da Vinci Jr. WiFi Pro

A compact 3D printer designed for professionals.

A compact 3D printer designed for professionals. The da Vinci Jr. WiFi Pro is packed with features and supports a range of filaments, letting you optimize print quality for your creative needs.



## Professional 3D Printing on Your Desk

Compact in size but so much you can do. The da Vinci Jr. WiFi Pro sits comfortably on your office desk or workbench, achieves a print size of 150 x 150 x 150 mm, and delivers consistent and quality prints.



## 3rd Party Materials and Software

Optimize print quality. Choose from a wide range of filaments like PLA, PETG, or metallic PLA, and easily fine-tune print settings in XYZmaker to match your material. Also supports G-code generated by other software like Cura and Slic3r, letting you print directly from an SD card.



Max. Print Speed

**160**  
mm /sec

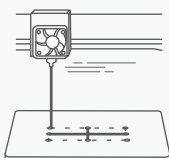

Layer Resolution

**20 - 400**  
microns

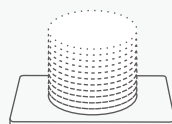

Max. Build Area

**150 x 150 x 150**  
mm

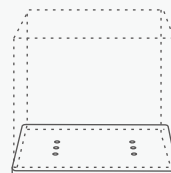

Materials

PLA / Tough PLA / PETG / Wood PLA /  
Antibacterial PLA /  
\*XYZ Carbon Fiber /  
\*Premium Metallic PLA  
(\*Optional Extruder)

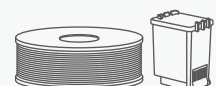

## Power Packed with Features You'll Love



Stainless Steel Nozzle for More Material Choices



9-Point Auto Calibration for Quality Prints

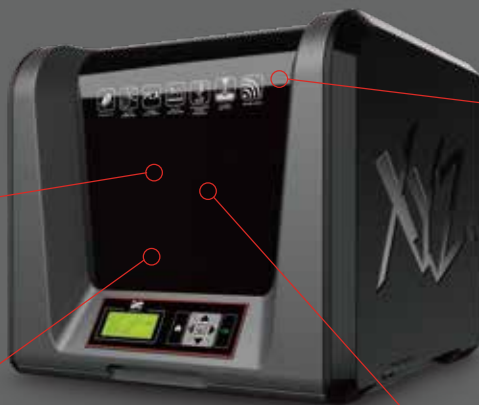

Built-in Wireless Device for Fuss-Free Wireless Printing



Added Functionality. With Optional Upgrades to our Steel Extruder and Laser Engraver Module

## Laser Engraving for a Professional Touch

Bonus. The da Vinci Jr. WiFi Pro comes with an optional laser engraving add-on. Simply swap the extruder for the laser engraver module. Use our dedicated software tool, XYZengraver and start engraving your own designs on paper, cardboard, leather, wood, and plastic.



## Wireless Printing for Added Convenience

Print from anywhere in your home, office, or workshop. Design your 3D models using our in-house app, XYZmaker Mobile on your tablet, and send it wirelessly for print over your WiFi network.

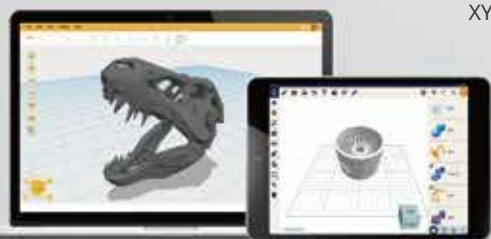

## Specifications

<b>Print Technology</b>	3D Structure Fused Filament Fabrication (FFF)	<b>Max. Moving Speed</b>	160 mm/s
<b>Max. Build Area (WxDxH)</b>	150 x 150 x 150 mm	<b>Print Bed</b>	Non-removable Glass
<b>Layer Resolution</b>	20 - 400 microns	<b>Leveling</b>	Auto
<b>XY Positioning Precision</b>	XY 12,5 microns	<b>Engraving Area</b>	150 mm x 150 mm
<b>Z Positioning Precision</b>	0.0004 mm	<b>Laser Wavelength</b>	450nm + 5nm/-10nm InGaN
<b>Supported File Formats</b>	stl / XYZ Format (.3w) / G-code / .3mf / .obj	<b>Output Power</b>	350mW ± 10%
<b>3D Builder Support</b>	Yes	<b>Supported Image Formats</b>	.jpg / .png / .gif / .bmp
<b>Material Compatibility</b>	PLA / Tough PLA / PETG / Wood PLA / Antibacterial PLA / *XYZ Carbon Fiber / *Premium Metallic PLA (*Optional Extruder)	<b>Connectivity</b>	USB 2.0 Cable / Wi-Fi 802.11 b/g/n / SD card
<b>Support 3rd Party Material</b>	Yes	<b>Operating Systems</b>	Windows 7 / 8 / 8.1 / 10 (64-bits) MAC OS X 10.10 / 10.11 / 10.12 / 10.13
<b>Filament Diameter</b>	1,75 mm	<b>Power Requirement</b>	100 V - 240 V 12 V/60 W
<b>Nozzle Diameter</b>	0,4 mm	<b>Product Dimensions (WxDxH)</b>	420 x 430 x 380 mm
		<b>Product Weight</b>	12 kg

\* Must be upgraded to Hardened Steel Nozzle

\*\* All features and specifications are subject to change without prior notice. For more information, please visit our website at [www.xyzprinting.com](http://www.xyzprinting.com)



**XYZ PRINTING**

[www.xyzprinting.com](http://www.xyzprinting.com)